

Master Links

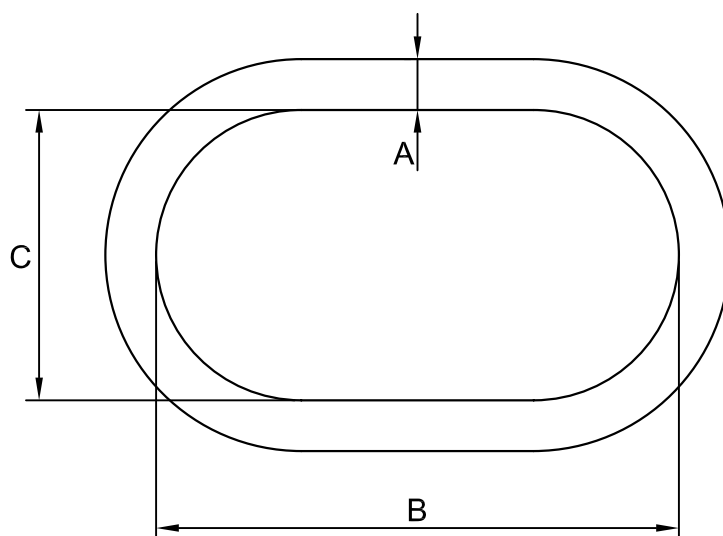

Safety Factor:BL equals 4xSWL

Finish:Painted

Materials:Forged

A(mm)	B(mm)	C(mm)	S.W.L(T)	B.L(T)	WEIGHT(KG)
14	144	80	1	4	0.51
18	144	80	2	8	0.87
22	144	80	3	16	1.33
26	180	100	5	20	2.2
32	216	120	8	32	4.2
35	216	120	10	40	5.1
38	252	140	12	48	7.0
42	288	160	16	64	9.7
45	288	160	20	80	11.2
52	324	180	25	100	16.9
55	360	200	30	120	21
60	360	200	40	160	25
75	396	220	50	200	34.5
94	396	220	63	252	40.5
120	430	240	80	320	55