

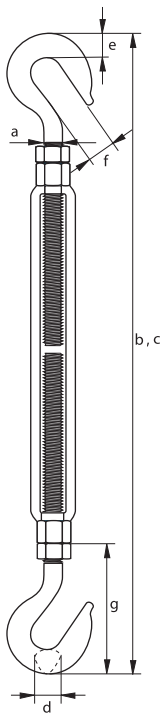

TB-HH



- **Materials** : Drop forged high tensile steel
- **Safety factor** : MBL equals 5 x WLL
- **Standard** : U.S. Federal Specification FF-T-791b
- **Finish** : Hot dipped galvanized
- **Certification** : A works certificate or proof load test certificate can be supplied upon request

diameter thread	take up	length closed position	length open position	thickness hook	thickness hook	opening hook	length closed position	working load limit	weight per pce
a	b	c	d	e	f	g	tons	kg	
inches	inches	mm	mm	mm	mm	mm	mm		
3/8	6	302	416	10	15	14	58	0.45	0.32
1/2	6	338	452	13	19	17	72	0.68	0.66
1/2	9	414	585	13	19	17	72	0.68	0.76
1/2	12	490	719	13	19	17	72	0.68	0.91
5/8	6	394	508	16	23	22	90	1.02	1.07
5/8	9	470	641	16	23	22	90	1.02	1.31
5/8	12	546	775	16	23	22	90	1.02	1.71
3/4	6	432	546	20	27	25	98	1.36	1.65
3/4	9	508	679	20	27	25	98	1.36	1.95
3/4	12	584	813	20	27	25	98	1.36	2.3
3/4	18	737	1080	20	27	25	98	1.36	2.85
7/8	12	625	854	23	30	29	126	1.81	3.33
7/8	18	778	1121	23	30	29	126	1.81	4.24
1	6	524	638	25	35	32	144	2.27	3.87
1	12	676	905	25	35	32	144	2.27	5.09
1	18	829	1172	25	35	32	144	2.27	6
1	24	980	1437	25	35	32	144	2.27	7.52
1 1/4	12	760	989	28	37	39	175	2.27	8.12
1 1/4	18	912	1255	28	37	39	175	2.27	10.4
1 1/4	24	1064	1521	28	37	39	175	2.27	12.1
1 1/2	12	823	1052	33	44	47	212	3.4	12.7
1 1/2	18	975	1318	33	44	47	212	3.4	15.1
1 1/2	24	1128	1585	33	44	47	212	3.4	17.1